

Boulevard Section

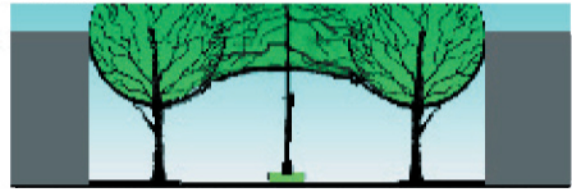

The compound canopy of convex-concave-convex gives a distinct identity to the shared space. Pedestrians have a personal space, while vehicles have a greater volume.

Boulevard Intersection with Primary Street



The continuous convex shapes of the canopy creates a curtain effect.

Boulevard Section with one-way alley exit

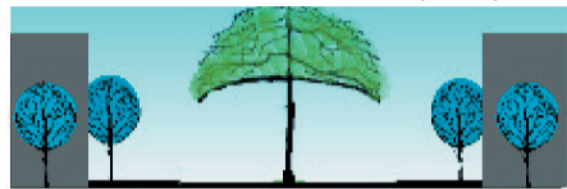

Smaller trees at alleys create pedestrians scale gateways. Recessed trees from curb to building help to define these entrances from the boulevard.

Harrisburg Design Guidelines

Harrisburg, PA
 Client: City of Harrisburg
 Completion: 2009
 Fees: \$97,000
 Role: Author



234 Liberty Street

Harrisburg, PA 17101

717.230.9660

Fax 717.230.9664

www.oparchitecture.com

OPA completed Design Guidelines for the City of Harrisburg. The Design Guidelines are composed of four sections: History and Analysis of Harrisburg, Residential Design Guidelines, Community Commercial Design Guidelines and Guidelines for Design of the Public Realm, which includes streetscape, landscape and lighting strategies.